

(1) SMR Code	(2) Federal Stock Number	(3) Description	(4) Unit of Meas.	(5) Qty	(6) 15-day Maintenance In Unit	(7) Organizational alw Illustration	(a) Figure	(b) Item No.	
Reference number & mfg. code			Usable on code	(a)	(b)	(c)	(d)	(a) Figure	(b) Item No.
GROUP 10-FRONT AXLE									
1000-FRONT AXLE ASSEMBLY									
PAOZZ	5315-752-1651	PIN, SHOULDER, HEADLESS: AXLE HOUSING 7521651(19207)	A	EA	6	* * * *	99	1	
PAOZZ	4730-954-1281	PLUG, PIPE: 1/4-18NPT, FRONT AXLE HOUSING MS490005-4(96906)	A	EA	2	* * * *	99	2	
PAOZZ	5330-839-9066	GASKET, ANNULAR: FILLER PLUG MS35769-21(96906)	A	EA	2	* * * *	99	3	
PAOZZ	4730-968-6129	PLUG, PIPE, MAGNETIC: 3/4-1/4 NPT MS490006-10(96906)	A	EA	1	* * * *	99	4	
PAOZZ	5365-732-6126	PLUG, MACHINE THREAD: 7326126(19207)	A	EA	1	* * * *	99	5	
1004-STEERING MECHANISM									
PAOZZ	2520-734-6991	FLANGE ASSEMBLY, DRIVE: 7346991(19207)	A	EA	2	* * * *	100	1	
PAOZZ	5340-734-6992	PLUG, EX: DRIVE FLANGE 7346992(19207)	A	EA	1	* * * *	100	2	
PAOZZ	5330-054-6865	PACKING, PREFORMED: 220984, (44674)	A	EA	1	* * * *	100	3	
PAOZZ	5306-752-1631	BOLT, MACHINE: FLANGE TO HUB 7521631 (19207)	A	EA	10	* * * *	100	4	
PAOZZ	5310-584-5272	WASHER, LOCK: FLANGE TO HUB MS35338-48(96906)	A	EA	10	* * * *	100	5	
XAOZZ		FLANGE, DRIVE: 8758278(19207)	A		1		100	6	
PAOZZ	2530-734-6993	GASKET: DRIVE FLANGE 7346993(19207)	A	EA	2	* * * *	100	7	
PAOZZ	2520-740-9550	SEAL, PLAIN, ENCASED: HUB BEARING, INNER FRONT 7409550(19207)	A	EA	2	* * * *	100	8	
PAOZZ	2520-740-9551	DEFLECTOR, DIRT AND MOISTURE: FRONT WHEEL BRAKE DRUMS 7409551(19207)	A	EA	2	* * * *	100	9	
PAOZZ	2530-734-6982	SPINDLE: WHEEL BEARINGS, W/BEARING 7346982(19207)	A	EA	2	* * * *	100	10	
PAOZZ	4730-050-4208	FITTING: STEERING KNUCKLE PLATE MS15003-1(96906)	A	EA	2	* * * *	100	11	
PAOZZ	5310-616-6354	WASHER, FLAT: SPINDLE STUD MS35335-38(96906)	A	EA	10	* * * *	100	12	
PAOZZ	5310-012-1983	NUT, PLAIN, HEXAGON: SPINDLE STUD 121983(21450)	A	EA	10	* * * *	100	13	

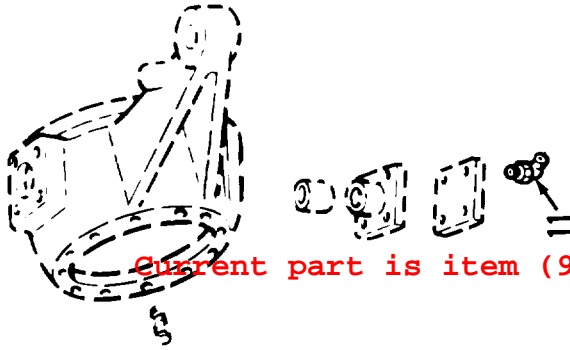

TA 009263

Current part is item (9) on diagram. Available at [www.oshkoshequipm](http://www.oshkoshequipm)

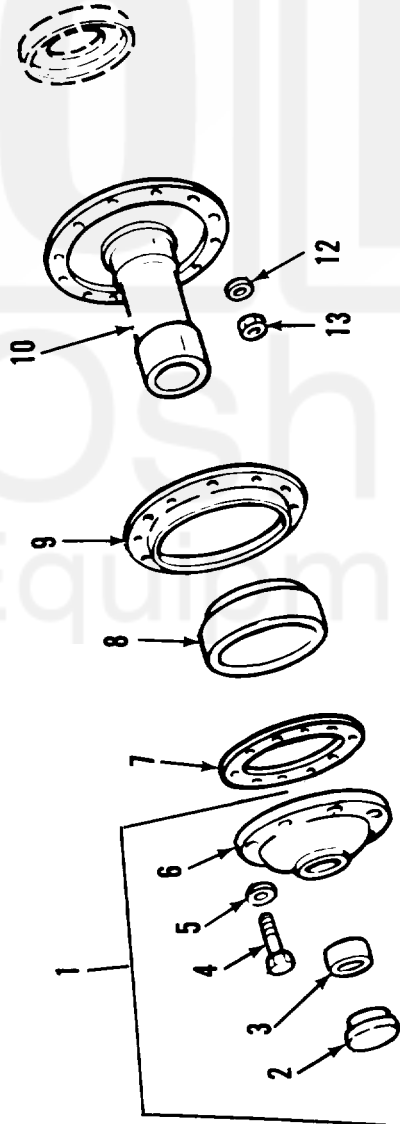

Figure 100. Steering knuckle and related parts.

Current part is item (9) on diagram. Available at [www.oshkoshequipm](http://www.oshkoshequipm)